

Variolink® Esthetic LC

Placement of Veneers (glass ceramic, composite)

Try-in

Variolink Esthetic Try-in

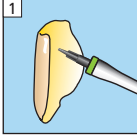

Application of Try-in paste

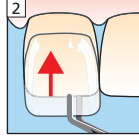

Try-in of restoration

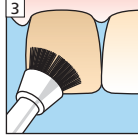

Cleaning after Try-in

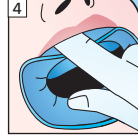

Isolation

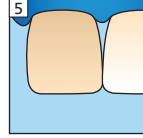

Restoration

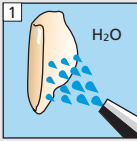

H₂O

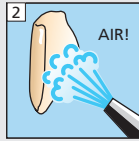

AIR!

Pre-treatment of ceramic restorations:
According to manufacturer's instructions
E.g. IPS Empress: Etch for 60 s
IPS e.max CAD/Press: Etch for 20 s
with IPS Ceramic etching gel (hydrofluoric acid). Follow safety instructions.

Pre-treatment of composite restorations:
According to manufacturer's instructions
E.g. SR Nexco, 2 bar, Al₂O₃ 100 µm
or roughened with finishing diamonds.

Monobond Plus

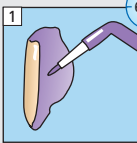

60 s

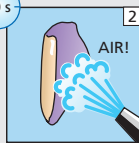

AIR!

Total Etch optional

Preparation

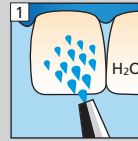

H₂O



AIR!

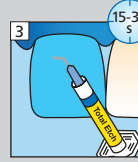

15-30 s

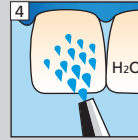

H₂O



AIR!



Adhese Universal

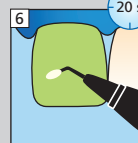

20 s

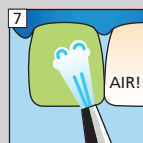

AIR!

Avoid pooling



Bluephase Style

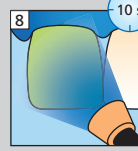

10 s

Cementation

Variolink Esthetic LC

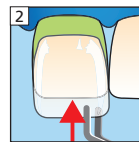
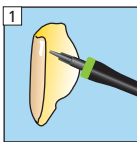

Bluephase Style

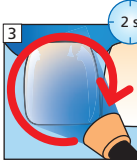

2 s

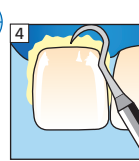

Secure the restoration until final polymerisation

Liquid Strip

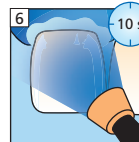
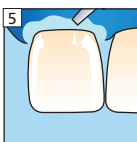

10 s

Polishing

Fluor Protector

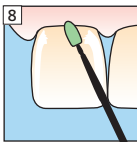

more information
www.cementation-navigation.com

CE 0123



Please read
Instruction for Use

ivoclar
vivadent
clinical

Date information prepared: 2014-06-25
666332/e/Rev. 0

Variolink® Esthetic LC

Placement of inlays (thickness < 2 mm) (glass ceramic, composite)

Try-in

Variolink Esthetic Try-in

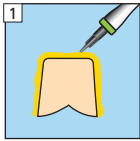

Application of Try-in paste

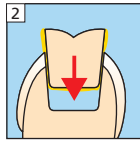

Try-in of restoration

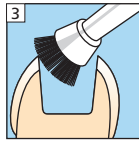

Cleaning after Try-in

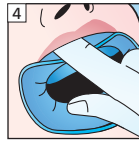

Isolation

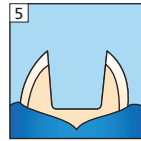

Restoration

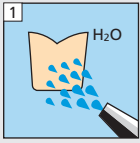

Pre-treatment of ceramic restorations:
According to manufacturer's instructions
E.g. IPS Empress: Etch for 60 s
IPS e.max CAD/Press: Etch for 20 s
with IPS Ceramic etching gel (hydrofluoric acid). Follow safety instructions.

Pre-treatment of composite restorations:
According to manufacturer's instructions
E.g. SR Nexco, 2 bar, Al₂O₃ 100 µm
or roughened with finishing diamonds.

Monobond Plus

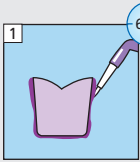

Total Etch optional

Preparation

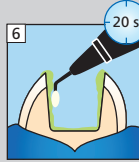
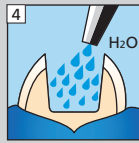
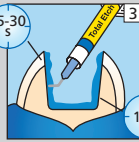
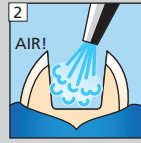
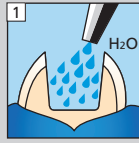

Avoid pooling



Bluephase Style

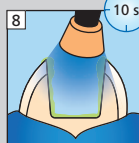

Cementation

Variolink Esthetic LC

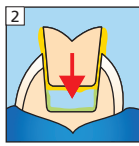
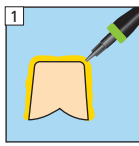

Bluephase Style

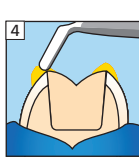
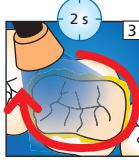

Secure the restoration until final polymerisation

Liquid Strip

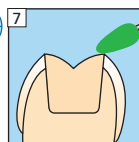
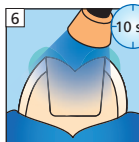
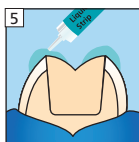

* per segment and mm ceramic

Polishing

Fluor Protector

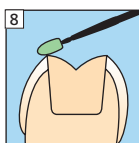

more information
www.cementation-navigation.com

CE 0123



Please read
Instruction for Use

ivoclar
vivadent
clinical