

Variolink Esthetic® DC

Placement of inlays (glass ceramic, composite)

Try-in

Variolink Esthetic Try-In

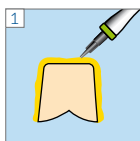

Application of Try-In paste

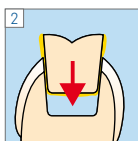

Try-in of restoration

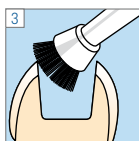

Cleaning after try-in

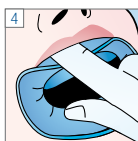

Isolation

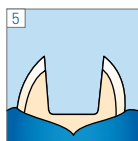

Restoration

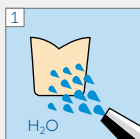

H₂O



AIR!

Pre-treatment of ceramic restorations:
According to manufacturer's instructions
E.g. IPS Empress: Etch for 60 s
IPS e.max CAD/Press: Etch for 20 s
with IPS Ceramic etching gel
(hydrofluoric acid). Follow safety
instructions.

Pre-treatment of composite restorations:
According to manufacturer's instructions
E.g. SR Nexco, 2 bar, Al₂O₃ 100 µm
or roughened with finishing diamonds.

Monobond Plus

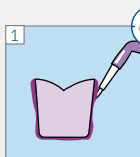

60 s



AIR!

Preparation

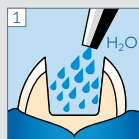

H₂O



AIR!

Total Etch:

optional

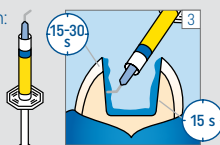

15-30 s

15 s

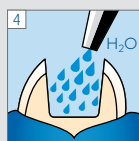

H₂O



AIR!

Adhese Universal

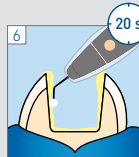

20 s

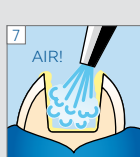

AIR!

Avoid pooling

Bluephase G4

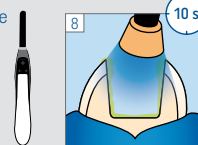

10 s

Cementation

Variolink Esthetic DC

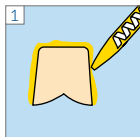

1

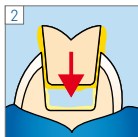

2

Bluephase G4



2 s

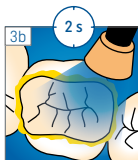

2 s

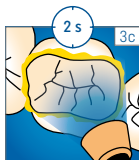

2 s

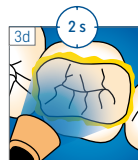

2 s

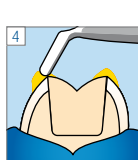

4

Secure the restoration until final polymerisation

Liquid Strip

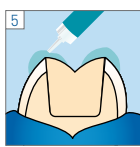

5

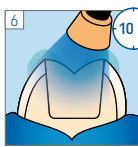

10 s



7

* per segment and mm ceramic

Polishing

Fluor Protector S

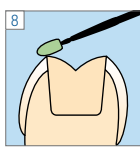

8



more information
www.cementation-navigation.com



CE 0123



See Instructions

Manufacturer
Ivoclar Vivadent AG
Benderstrasse 2
9494 Schaan/Liechtenstein
www.ivoclar.com

Date information prepared:
2022-08-23
666357/EN/Rev. 1

ivoclar

Variolink Esthetic® DC

Placement of crowns and bridges (glass ceramic, oxide ceramic, composite)

Variolink
Esthetic
Try-In



Try-in

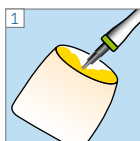

Application of
Try-in paste

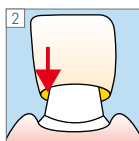

Try-in of
restoration



Cleaning after
try-in

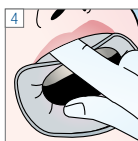

Isolation

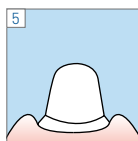

Restoration

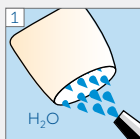

Pre-treatment of glass ceramic restorations:

According to manufacturer's instructions

E.g. IPS Empress: Etch for 60 s

IPS e.max CAD/Press: Etch for 20 s

with IPS Ceramic etching gel

(hydrofluoric acid). Follow safety

instructions.

Pre-treatment of oxide ceramic restorations:

According to manufacturer's instructions

E.g. IPS e.max ZirCAD

max. 1 bar, Al_2O_3 100 µm

Pre-treatment of composite restorations:

According to manufacturer's instructions

E.g. SR Nexco, 2 bar, Al_2O_3 100 µm

or roughened with finishing diamonds.

Monobond
Plus

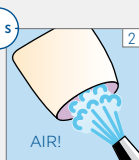
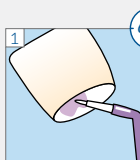

60 s

AIR!

Preparation

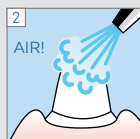

Total Etch:

optional

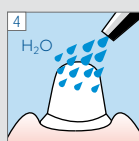
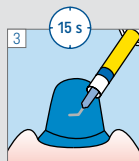

Adhese
Universal

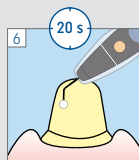

Avoid pooling

Bluephase
G4

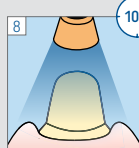

10 s

Cementation

Variolink
Esthetic DC

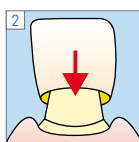
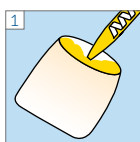

Bluephase
G4

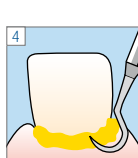
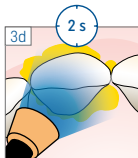
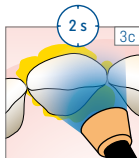
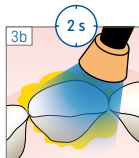
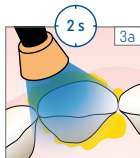

Secure the restoration until final polymerisation

Liquid
Strip

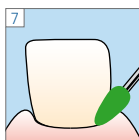
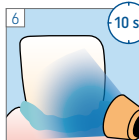
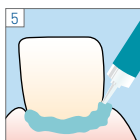

* per segment and
mm ceramic

Polishing

Fluor
Protector S

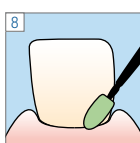

more information
www.cementation-navigation.com



CE 0123



Manufacturer
Ivoclar Vivadent AG
Benderstrasse 2
9494 Schaan/Liechtenstein
www.ivoclar.com

Date information prepared:
2022-08-23
666357/EN/Rev. 1

ivoclar